

# TN-DB Doorbell Intelligent Touch Panel

TN-DB series doorbell system is the newest design for easy operation. The system includes a mechanical bell chime that generates clear enough natural metallic sound. The bell system works stably with MCU programmable circuit control. One gang is for 'do not disturb', the other gang is for 'make up' (if one more gang is for 'please wait'). The gangs are inter-locking with each other for exactly hotel function design. Installation is easy, fitting for installing to UK standard square wall box.

TN-DB series doorbell system is widely applied to hotels, motels, and apartments that require indication signal out of rooms.



TN-DB20-TO



## Product Feature:

- Super luxury design with metal frame and PC isolated material. Multiple color available for choosing.
- Dark back light to ensure visible in dark.
- Metallic sound for clear and pleasing to ear.

## ITEM NO.

- TN-DB2051/TN-DB2051R/TN-DB2051W
- TN-DB2301/TN-DB2301R/TN-DB2301W

Color for reference: White (the default color), Red, Pink, Gold, Blue, Grey, Silver, and Black.

Metal frame for reference: Satin Chrome, Pearl Chrome, Mirror Gold, Mirror Chrome, and Satin Gold.



# SPECIFICATIONS

- ① Mount the fixed bracket on the switch wall box.

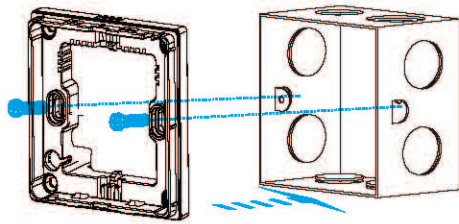

- ② Dismounting method of touch panel and fixed bracket

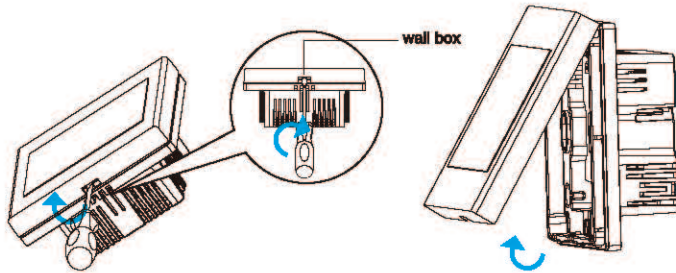

- ③ Fix the doorbell in proper position and connect the network cable cat.5 according to the cabling diagram

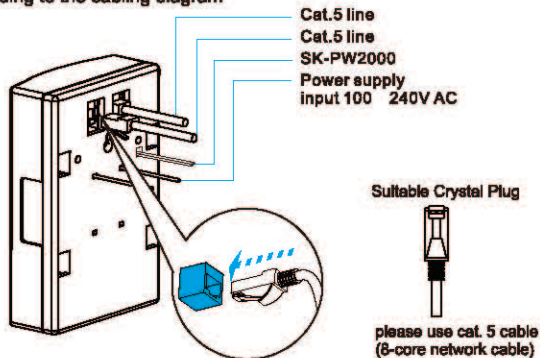

- ④ Draw out network cable from BS4662 wall box and trim up, press tightly on terminal block as illustration, cover the plate

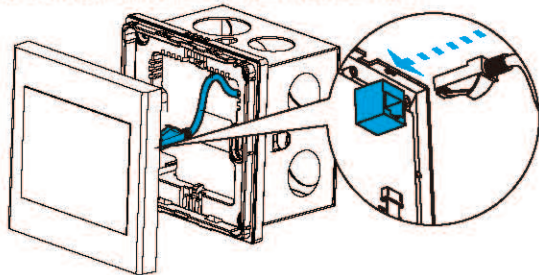

## Product Operation

- The guest inside the room touches on the indoor touch panel to control the indication at the outdoor touch panel.
- When 'do not disturb' is turned on in indoor touch panel, the outdoor shows the same and the doorbell can't work in order not to disturb the guest.
- When 'make up' is turned on in indoor touch panel, the outdoor shows the same and the doorbell still works. If the system is with a 'please wait' function, when turn on 'please wait' indoor, the outdoor 'please wait' will sparkle for 2 minutes then to turn off automatically.

## Specification

- Distance of network cable connection: < 100m
- Voltage: 50/60Hz 100 ~ 240VAC
- Mounting centre: 60.3mm (for BS4662 wall box)
- Bell chime dimension: 155mm x 105mm x 45mm
- Operate temperature: -10°C ~ 50°C
- Operate humidity: 0 ~ 95%
- Touch panel dimension: 86mm x 86mm x 25mm

## Wiring & Installation

### TN-DB/TN-DBR cabling Diagram

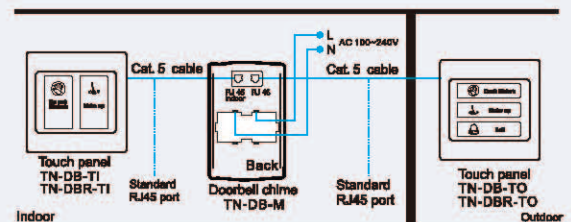

Note: Connect indoor-RJ45 port on TN-DB-M control unit to TN-DB-TI touch panel with cat.5 cable; connect the other RJ45 port on TN-DB-M control unit to TN-DB-TO touch panel with cat.5 cable.

### TN-DBW Cabling Diagram

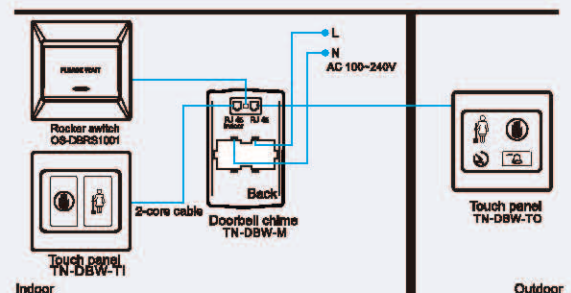

Note: Connect indoor-RJ45 port on TN-DBW-M control unit to TN-DBW-TI touch panel with cat.5 cable; connect the other RJ45 port on TN-DBW-M control unit to TN-DBW-TO touch panel with cat.5 cable.

## Standard and Certificate

The product is design and produced in accordance with CE and RoHS.

## Trouble Shooting Guide

Symptom	Possible cause	Solution
No backlight of the touch panel	1. Incorrect wiring or poor contact.	Ensure that input wire and output wire are tightly fixed on the terminal blocks.
	2. Cut of Main switch or creepage protection switch	Turn on the main switch or creepage switch. if still trip, please check equipment if there is creepage.
Ceaseless flash of the touch panel	1. Broken or invalid of the touch panel	Replace the touch panel immediately.
	2. Touch panel enters self-protection	Cut off power and restart
Bell Chime doesn't work	1. Current over load	Connect less appliance to the circuit. And try again, if still doesn't work, user have to replace the drive of the bell chime.
The touch panel can not work abnormally	Wrong connection of network cable or no connection with correct ports	Check the network cable and ensure correct connection of output ports to the corresponding terminal in the touch panel.

**Warning:** Please install contactor to help connect the card key switch if this card key switch is as be main switch to afford over current (i.e. air-condition system).